

1. Power light
2. Drive activity lights
3. USB 2.0
4. Mode configuration switches
5. Power
6. Power button

1. Flip the switches to set the mode.

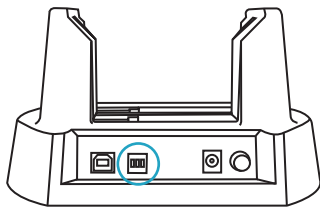

↓ = 0, ↑ = 1
Example:

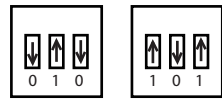

Windows Vista / 7
Mac OS X 10.4+

001	JBOD
101	RAID 0
011	RAID 1
111	Spanning

Windows XP*

000	JBOD
100	RAID 0
010	RAID 1
110	Spanning

Caution: When using hard drives in the dock after being previously setup, make sure the mode of the dock is set to the same mode of the hard drive as when the drives were initially set up. Insert the drives in the same order and same bay as during the initial setup. Switching modes or bays might result in data loss.

For example, if a pair of hard drives was initially set up as RAID 0, make sure the dock is in RAID 0 mode before inserting the hard drives again. Also, if a particular drive was in Bay-1 during the initial setup, Bay-1 must be used again for this particular drive and vice versa.

2. Insert 2.5" or 3.5" SATA drives into the dock.

One or two drives can be accessed in JBOD mode. RAID 0 and RAID 1 require two identical drives (same model and capacity) for optimum performance. JBOD and Spanning can use any combination of drives.

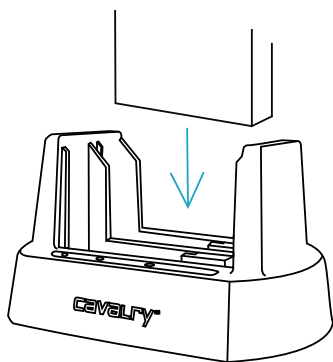

Note: Ensure a proper connection when inserting a drive by putting it straight down and not tilting it. If a drive is not being detected, turn off the dock then remove and re-insert the drive.

3. Connect the USB and power cables then turn the dock on with the power button. Wait until your computer detects the dock then begin transferring files. New hard drives need to be initialized and formatted.

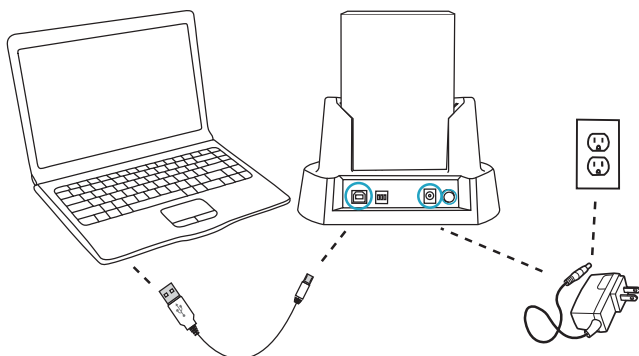

Note: Depending on the drives used, when powering on, allow up to 30 seconds for both drives to spin up to speed.

Caution: Removing the hard drives from the dock while it is on may result in data loss. Before turning off the dock, make sure the hard drives are not busy as indicated by the solid green "Hard Disk Access" lights on the front of the dock.

Modes

JBOD

Accesses the two hard drives separately as "Just a Bunch Of Disks" so that two individual drives will appear on the computer. Use this mode if accessing single drives. Usable capacity is the sum of the drives.

RAID 0

Increases data transfer speeds as both drives are used simultaneously. A single file is "striped" or split up and written across both drives. Both drives will be displayed as a single unit on the computer. Usable capacity is the sum of the drives.

RAID 1

Clones or "mirrors" the same data onto both drives simultaneously so only half the total capacity of both drives are utilized. If one drive should fail, the surviving drive will have a backup of the data from the failed drive. The usable capacity is **half** the sum of the drives.

Spanning

Combines the capacity of both drives, similar to RAID 0, but instead fills up one disk first before filling the second disk. Usable capacity is the sum of the drives.

Troubleshooting

I can't see the hard drives.

Make sure the power is on and the SATA hard drives have been inserted straight in and not tilted. Also check all the connection points as well as the USB ports on the computer as they may be defective.

One of the drives failed in RAID 1, how do I recover my data?

When one of the drives in RAID 1 fails, you can either (A) switch the dock to JBOD mode to recover the data from the surviving drive or (B) insert a new identical hard drive (same model and capacity) into the other bay and it will automatically be rebuilt from the data located on the surviving drive. Option B is recommended and will allow you to always have two copies of the data. Do not power off the dock until rebuilding has been complete.

How do I initialize / format the hard drives?

Hard drives that have not been initialized may not show up on the computer. Go to Disk Management (Windows) or Disk Utility (Mac) and follow the instructions to initialize and/or format the hard drives.

*Due to operating system limitations, Windows XP can only access up to 2TB, even if the actual total capacity is greater. These switch configurations will allow the computer to access up to 2TB on drives or combinations of drives with a usable capacity greater than 2TB. DO NOT insert hard drives if the existing data totals more than 2TB as Windows XP might overwrite or delete it.

Contact Us

Call: 800.238.4453 (toll-free, USA only)
805.426.1000

Email: customer.support@cavalrystorage.com

Website: www.cavalrystorage.com